

Carbide rods



Table of grade and properties of carbide rods

GRADE	ISO CODE	COBALT CONTENT	DENSITY	HARDNESS	TRS
		(%)	g/cm ³	HRA	N/mm ²
K10T	K05-K10	4.5-6.0	14.95-15.05	92.7	1800
YG8	K30	8	14.80	89.5	2200
YG6	K20	6	14.95	90.5	1900
YG6X	K10	6	14.95	91.5	1800
YL10.2	K30	10	14.50	91.8	2400
YG13X	K30-K40	13	14.30	89.5	2600
YG15	K40	15	14.00	87.5	2800

Solid rods without hole

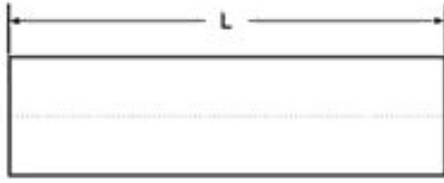

Article number	D (mm)	Dia. Tolerance (mm)	L(mm)	L. tolerance (mm)
GH0120	1.2	+0.2	330	+2.0
GH0170	1.7	+0.2	330	+2.0
GH0220	2.2	+0.2	330	+2.0
GH0270	2.7	+0.2	330	+2.0
GH0320	3.2	+0.2	330	+2.0
GH0370	3.7	+0.2	330	+2.0
GH0420	4.2	+0.2	330	+2.0
GH0470	4.7	+0.2	330	+2.0
GH0520	5.2	+0.2	330	+2.0
GH0570	5.7	+0.2	330	+2.0
GH0620	6.2	+0.2	330	+2.0
GH0620	6.7	+0.2	330	+2.0
GH0720	7.2	+0.2	330	+2.0
GH0770	7.7	+0.2	330	+2.0
GH0820	8.2	+0.3	330	+2.0
GH0920	9.2	+0.3	330	+2.0
GH0970	9.2	+0.3	330	+2.0
GH1020	10.2	+0.3	330	+2.0
GH1070	10.7	+0.3	330	+2.0
GH1120	11.2	+0.3	330	+2.0
GH1170	11.7	+0.3	330	+2.0
GH1220	12.2	+0.3	330	+2.0
GH1270	12.7	+0.3	330	+2.0
GH1320	13.2	+0.3	330	+2.0

GH1370	13.7	+0.3	330	+2.0
GH1420	14.2	+0.3	330	+2.0
GH1470	14.7	+0.3	330	+2.0
GH1520	15.2	+0.3	330	+2.0
GH1570	15.7	+0.3	330	+2.0
GH1620	16.2	+0.4	330	+2.0
GH1670	16.7	+0.4	330	+2.0
GH1720	17.2	+0.4	330	+2.0
GH1770	17.7	+0.4	330	+2.0
GH1820	18.2	+0.4	330	+2.0
GH1870	18.7	+0.4	330	+2.0
GH1920	19.2	+0.4	330	+2.0
GH1970	19.7	+0.4	330	+2.0
GH2020	20.2	+0.5	330	+2.0
GH2070	20.7	+0.5	330	+2.0
GH2120	21.2	+0.5	330	+2.0
GH2170	21.7	+0.5	330	+2.0
GH2220	22.2	+0.5	330	+2.0
GH2270	22.7	+0.5	330	+2.0
GH2320	23.2	+0.5	330	+2.0
GH2370	23.7	+0.5	330	+2.0
GH2420	24.2	+0.5	330	+2.0
GH2470	24.7	+0.5	330	+2.0
GH2520	25.2	+0.5	330	+2.0

Solid rods with single coolant hole

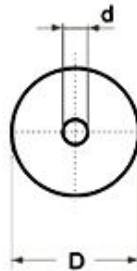
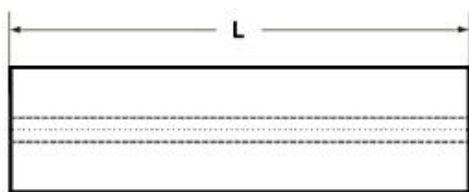

Article number	D (mm)	Dia. Tolerance (mm)	Hole (mm)	L (mm)	L. tolerance (mm)
GH0330-0.3	3.3	+0.2	0.3	330	+2.0
GH0495-0.6	4.95	+0.2	0.6	330	+2.0
GH0630-0.12	6.3	+0.2	0.12	330	+2.0
GH0630-0.18	6.3	+0.2	0.18	330	+2.0
GH0630-1.0	6.3	+0.2	1.0	330	+2.0
GH0645-1.0	6.45	+0.2	1.0	330	+2.0
GH0730-1.1	7.3	+0.2	1.1	330	+2.0
GH0830-1.3	8.3	+0.2	1.3	330	+2.0
GH0855-2.0	8.55	+0.2	2.0	330	+2.0
GH0930-1.3	9.3	+0.2	1.3	330	+2.0
GH1030-2.0	10.3	+0.2	2.0	330	+2.0
GH1055-2.0	10.55	+0.2	2.0	330	+2.0
GH1130-2.0	11.3	+0.2	2.0	330	+2.0
GH1230-2.0	12.3	+0.2	2.0	330	+2.0
GH1255-2.0	12.55	+0.3	2.0	330	+2.0
GH1330-2.0	13.3	+0.3	2.0	330	+2.0
GH1430-2.0	14.3	+0.3	2.0	330	+2.0
GH1470-2.0	14.7	+0.3	2.0	330	+2.0
GH1630-2.0	16.3	+0.4	2.0	330	+2.0
GH1670-2.0	16.7	+0.4	2.0	330	+2.0
GH1730-2.0	17.3	+0.4	2.0	330	+2.0
GH1750-2.0	17.5	+0.4	2.0	330	+2.0
GH1830-3.0	18.3	+0.5	3.0	330	+2.0
GH1870-3.0	18.7	+0.5	3.0	330	+2.0
GH2030-3.0	20.3	+0.5	3.0	330	+2.0
GH2070-3.0	20.7	+0.5	3.0	330	+2.0
GH2230-3.0	22.3	+0.5	3.0	330	+2.0

Solid rods with double coolant holes

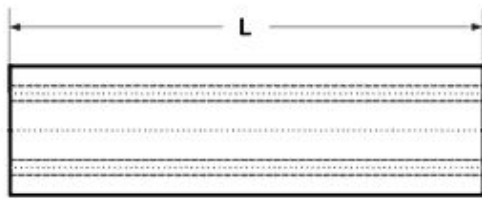

Article number	D (mm)	D1 (mm)	d (mm)	L(mm)	L. tolerance (mm)
GH0420-1.5-0.9	4.2	1.5	0.9	330	+2
GH 0520-2.0-0.9	5.2	2.0	0.9	330	+2
GH 0620-2.0-0.9	6.2	2.0	0.9	330	+2
GH 0720-2.0-0.9	7.2	2.0	0.9	330	+2
GH 0820-2.0-1.0	8.2	2.0	1.0	330	+2
GH 0920-2.0-0.9	9.2	2.0	0.9	330	+2
GH 1020-2.0-1.0	10.2	2.0	1.0	330	+2
GH 1120-5.0-2.0	11.2	5.0	2.0	330	+2
GH 1220-5.0-2.0	12.2	5.0	2.0	330	+2
GH 1320-5.4-2.0	13.2	5.4	2.0	330	+2
GH 1420-5.0-2.0	14.2	5.0	2.0	330	+2
GH 1520-5.0-2.0	15.2	5.0	2.0	330	+2
GH 1620-5.0-2.0	16.2	5.0	2.0	330	+2
GH 1720-6.2-2.0	17.2	6.2	2.0	330	+2
GH 1820-7.0-2.0	18.2	7.0	2.0	330	+2
GH 1920-6.2-2.0	19.2	6.2	2.0	330	+2
GH 2020-6.0-2.0	20.2	6.0	2.0	330	+2
GH 2220-7.0-2.0	22.2	7.0	2.0	330	+2
GH 2540-8.0-2.0	25.4	8.0	2.0	330	+2

All dimensions are in mm

We can produce according to customer's request.